

LMR2016

Rechargeable Lithium Manganese Dioxide Coin Cell 3.0 V

Specifications

Renata Type LMR2016
Part Number 100775 (IB)
Batteries with tabs On request
UL Recognition MH14002

Nominal Voltage 3.0 V
Standard Capacity 30 mAh
(load 5.6 k Ω , cut off 2.0 V at 23°C)

Internal Impedance Initial max. 30 Ω (measured at 23°C, 1 kHz)
After 12 month storage at 23°C max. 35 Ω

Thickness (T) 1.60 +0.2 / -0.2 mm
Diameter (D) 20.0 +0 / -0.2 mm
Weight ~ 1.2 g

Charging Characteristic CC/CV – Constant Current / Constant Voltage
Voltage (intermittent charging) 3.25 V CV
Voltage (continuous charging) 3.10 V CV
Current Normal 0.3mA
Max. Charging Current 10mA
Temperature at charging - 20 °C - 60 °C

Discharge Characteristic
Cut off Voltage 2.0 V
Max discharge current 8mA (continuous); 20mA (pulse)
Temperature during discharge -20°C - 60°C
Discharge capability \geq 50% of nominal capacity at 8 mA discharge
Cycle life at room temperature > 500 cycles (20 % depth of discharge)

Storage 10°C - 30°C, \leq 60 % r.H. (in case of storage for more than one month)
Self discharge rate <1% / year at 23°C

Dimensions

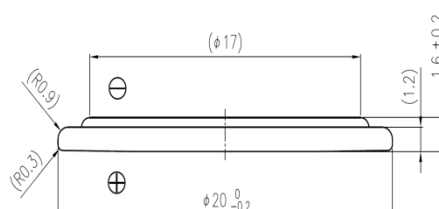

LMR2016

Rechargeable Lithium Manganese Dioxide Coin Cell 3.0 V

Typical Battery Performance

Charge Characteristic at 25 °C

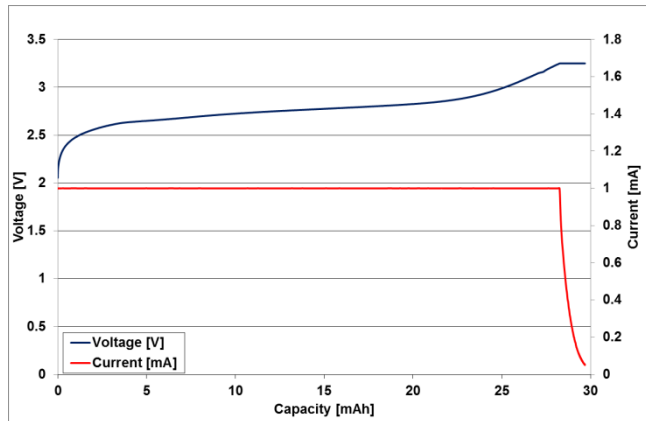

Cycle Life Characteristic

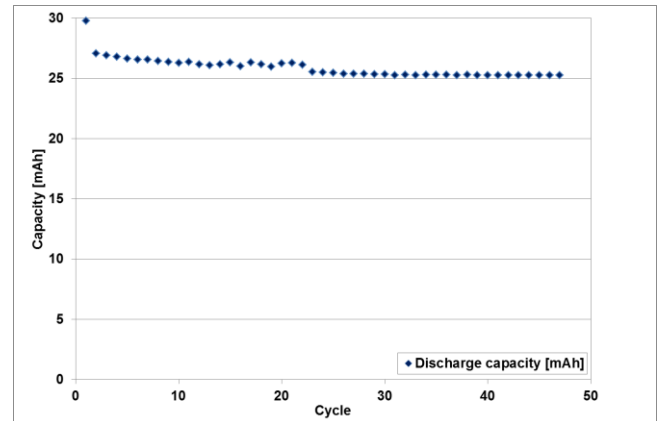

Discharge Characteristic at 25°C

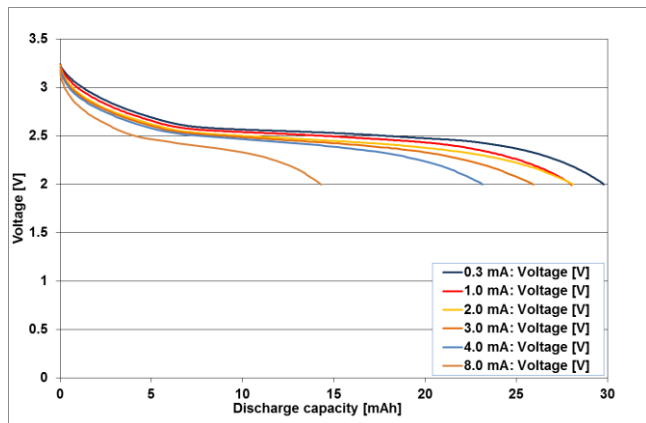

Temperature performance at 0.2 mA

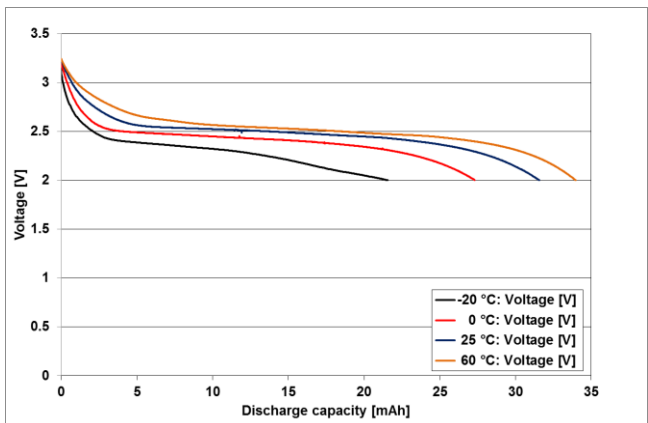

Information and contents in this data sheet are for reference purpose only. They do not constitute any warranty or representation and are subject to change without notice. For most current information and further details, please contact your Renata representative. For safety related information please consult the ASDS document related to that product or product family. The Products of Renata SA are neither designed nor authorized for use in certain areas of application of environment. For further details we refer to our webpage www.renata.com/downloads/restriction_of_use